

Spa and Wellness Facility, Bad Tölz (GER)

project	Construction of a new spa and wellness facility located in Bad Tölz
awarding authority	City of Bad Tölz (GER)
participation	restricted competition
services	WW+, Esch-sur-Alzette (LUX) / Trier (GER) architecture
rendering	rendertaxi, Aachen (GER)
facts	<ul style="list-style-type: none">- 5 different spa areas including rest rooms- restaurant with around 80 seats / retailshop- ergo therapy area- privat spa area- parking garage with around 60 parking spaces
dates and numbers	
gfa	4.066 m²
ufa	2.905 m²
gv	16.670 m³
total area	0,9 ha
competition phase	07/2016 - 09/2016

"All that is against nature cannot last in the long run."

Charles Darwin

The unique geology and geography of the surroundings is what characterises the overall sculptural and typological structure of the planned themed sauna Natura Tölz. The architectural concept, the staging of the individual functional units, respectively the themed areas, and the design of the outdoor facilities all systematically descend from the existing natural environment.

Genius Loci – sauna landscape in the flow of nature

The distinctiveness of the site, between Uferstraße on the Isar wetlands and the fringes of the garden-city residential area, provides only limited urban planning specifications, resulting in the basic concept of a sauna landscape in the flow of nature. The architectonic concept foresees a compact building form, in a bid to reduce built-up surfaces in favour of a green setting, which places particular emphasis on a harmonious integration into the surrounding natural environment. Given its cubature, the building forms a clear-cut and distinctive edge towards Bockschützstraße. Given the stand-alone and flared design of the volume, it opens up towards the adjacent biotope, along the slope edge of the Isarleitenweg residential area. The designed interior of the sauna garden and the large open forecourt form a visually interpreted, flowing connection between the new building of the 'Sauna Natura Tölz' and the existing natural and green environment. The result is a design that – with its distinctive shape and clearly defined interior structure – provides its users with a sense of direction and security. The architecture of the building, which clearly stands out from the surrounding structures, immediately discloses its special role. In line with this character is the discreet yet sculptural design of the building. The architectonic expression is above all defined by the striking timber façade. The scaling down to just a few, authentic materials results in a discreet and timeless aesthetic. Closed along Bockschützstraße and open towards the green area, the exterior of the building already conveys a holistic approach.

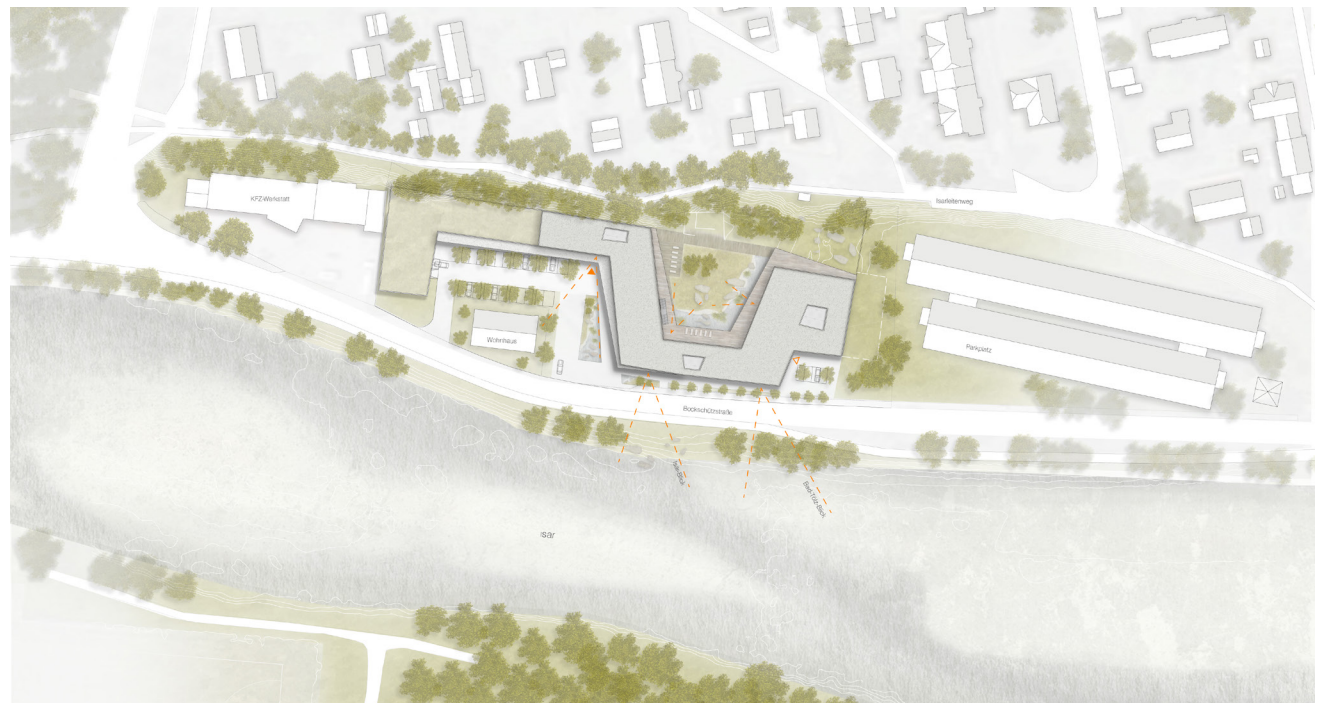

site plan



elevation



section



ground floor



Construction & material | Scenography & storytelling

The word ambience comes from the Latin *ambiens*, meaning 'circulating'. A visit to Natura Tölz is like taking a walk along the Isar and on their way through the different theme worlds visitors find inner peace and balance in accordance with the guiding principle and holistic approach of Dr Klingelhöfer. Natura Tölz will feature the distinctive materials of wood, stone, clay and water. As a natural, contemporary and sustainable regional material, wood is found in both the construction and the surfaces of the façade and the interior work. Wood is a sensual material, people like to touch it and love its smell. As a renewable resource, it is CO2 neutral, robust and easy to work with. Stone in the form of a terrazzo surface finds its application in the heavy-use water areas and as a floor covering. The material leaves a striking impression and, in matching the natural colour of the wood, further enhances the cosy atmosphere created by the wood surfaces. Terrazzo is manufactured by hand, it is robust, easy-care and low maintenance. Great stone blocks, reminiscent of the bed load stones of the Isar, are used in the sauna garden and the areas in front of the saunas to create different zones and seating options. Clay plaster is envisaged for the wall and ceiling surfaces. Given its excellent climatic characteristics, it is ideal for use in a wellness facility. The individual theme areas feature finely tuned lighting moods in a given colour spectrum. A selection of photographs and pictures will complement the ensuing unique atmosphere of Natura Tölz, in particular in the theme saunas. The arrangement of the sauna areas according to the times of day that accompany each theme takes visitors on a multifaceted journey through the building. The circulation areas – in their layout in terms of space and design – enhance the specifically targeted level of transparency and seclusion. Spatially and visually, this leads to an intertwining of various room zones. This has a positive influence on the internal communication as well as the interaction between the building and the sauna garden. The construction of the new Natura Tölz provides an opportunity to complement the immediate surroundings – characterised by residential and commercial buildings – with a public place that has so far been lacking. As a central cornerstone of cultural life in this part of Bad Tölz, together the building and its site form a new centre, which will see the precinct on the river bank used by locals and tourists alike.